

Description	Dimensions	Colour	Weight (kg)	£ ea. +VAT
ATLANTIC Balustrades				
ROYAN baluster	590mm x 160 x 160	White or Buff	14.0	£35.22
SOULAC baluster	730mm x 160 x 160	White or Buff	17.0	£47.39
Atlantic Coping / Plinth (standard)	495mm x 245 x 80	White or Buff	17.0	£32.25
Pillar cap, flat (standard)	320mm x 320 x 80	White or Buff	16.0	£48.63
Pillar blocks (standard)	250mm x 250 x 167	White or Buff	7.0	£17.16
Baluster cubes for stairs	160mm x 160 x 200	White or Buff	10.0	£21.48
Fixing Dowels	-	-	-	£0.54
Weser-Mix JM Fixing Mortar	15 kg	White or Buff	15.0	£58.62
BERGERAC Paving & Pool Copings (wet-cast)				
Bergerac Paving	495mm x 495 x 35	Champagne	18.5	£13.31
Straight (495mm)	495mm x 310	Champagne	12.0	£23.76
Internal corner R150	495mm x 495 x 310	Champagne	17.0	£45.57
Radiused coping R1500	480mm x 310	Champagne	11.0	£31.92
Roman ext. angle right	400mm x 400	Champagne	10.0	£50.31
Roman ext. angle left	400mm x 400	Champagne	10.0	£50.31
AQUITAINE - 13" Pool Copings (dry-cast)				
Straight (500mm)	500mm x 330	White or Buff	17.0	£18.14
Internal corner R150	500mm x 500 x 330	White or Buff	21.0	£31.78
Radiused coping R1500	490mm x 330	White or Buff	16.0	£22.96
Roman ext. angle right	400mm x 400	White or Buff	15.0	£34.89
Roman ext. angle left	400mm x 400	White or Buff	15.0	£34.89
Aquitaine / Atlantic Paving	500mm x 500 x 35	White or Buff	18.0	£10.94
Weser-Mix JL Jointing Mix	25 kg	White or Buff	25.0	£46.96
DECO - 11½" Pool Copings (dry-cast)				
Straight (500mm)	500mm x 290	White or Buff	12.0	£17.05
Internal corner R150	430mm x 430 x 290	White or Buff	15.5	£28.66
Aquitaine / Atlantic Paving	500mm x 500 x 35	White or Buff	18.0	£10.94
Weser-Mix JL Jointing Mix	25 kg	White or Buff	25.0	£46.96
PERIGORD - 9" Flat Top Pool Copings (dry-cast)				
Straight (500mm)	500mm x 225	White or Buff	9.3	£12.21
Internal corner R150	-	White or Buff	0.0	£27.30
Aquitaine / Atlantic Paving	500mm x 500 x 35	White or Buff	18.0	£10.94
Weser-Mix JL Jointing Mix	25 kg	White or Buff	25.0	£46.96
CHAMBORD Pillars				
Complete Pillar, 1930mm Tall	1930mm x 400 x 400	White	275.0	£899.99
Pier Caps				
Medium	400mm x 400	Buff	26.3	£61.27
Large	500mm x 500	Buff	42.3	£76.59
Wall Copings				
Saddleback Copings, 180 wide x 49/40	490mm x 180 x 40	White or Buff	7.5	£12.99
Saddleback Copings, 300 wide x 75/40	990mm x 300 x 40	White or Buff	29.5	£42.74
Saddleback Copings, 450 wide x 62/40	490mm x 450 x 40	White or Buff	22.0	£28.70

Description	Dimensions	Colour	Weight (kg)	£ ea. +VAT
Window Cills (Sills)				
665mm	665mm x 150 x 140	Buff	26.2	£41.11
693mm	693mm x 150 x 140	Buff	27.3	£42.84
778mm	778mm x 150 x 140	Buff	30.7	£48.19
835mm	835mm x 150 x 140	Buff	32.9	£51.62
890mm	890mm x 150 x 140	Buff	35.1	£55.02
1003mm	1003mm x 150 x 140	Buff	39.5	£61.94
1120mm	1120mm x 150 x 140	Buff	44.1	£69.24
1228mm	1228mm x 150 x 140	Buff	48.4	£75.82
1340mm	1340mm x 150 x 140	Buff	52.8	£82.84
1405mm	1405mm x 150 x 140	Buff	55.4	£86.86
1547mm	1547mm x 150 x 140	Buff	61.0	£95.64
1975mm	1975mm x 150 x 140	Buff	77.8	£122.09
2015mm	2015mm x 150 x 140	Buff	79.4	£124.57
2544mm	2544mm x 150 x 140	Buff	100.2	£157.27
Window Heads (Headers / Lintels)				
693mm	693mm x 100 x 215	Buff	32.0	£48.14
835mm	835mm x 100 x 215	Buff	38.6	£58.04
1120mm	1120mm x 100 x 215	Buff	51.7	£77.80
1405mm	1405mm x 100 x 215	Buff	64.9	£97.62
1547mm	1547mm x 100 x 215	Buff	71.5	£107.47
1975mm	1975mm x 100 x 215	Buff	91.2	£137.24
2005mm	2005mm x 100 x 215	Buff	92.6	£139.89
2544mm	2544mm x 100 x 215	Buff	117.5	£176.62
Clip Keystones				
Clip Keystones	693mm x 100 x 215	Buff	13.0	£41.35
Quoins				
Chamfered Quoins	348/233 x 118 x 215	Buff	24.0	£22.20
Plain Quoins	330/215 x 100 x 215	Buff	20.0	£19.35
COLUMNS				
Shaft, 260mm dia.	260 dia x 250 tall	White or Buff	14.0	£71.17
Base, 260mm dia.	260/380 dia x 170	White or Buff	22.0	£205.93
Capital, 260mm dia.	260/380 dia x 170	White or Buff	22.0	£205.93
Square Plinth for 260mm dia.	400mm x 400 x 80	White or Buff	21.0	£89.42
Shaft, 350mm dia.	350 dia x 250 tall	White or Buff	23.0	£78.85
Base, 350mm dia.	350/500 dia x 200	White or Buff	38.0	£247.68
Capital, 350mm dia.	350/500 dia x 200	White or Buff	38.0	£247.68
Plinth for 350mm dia.	520mm x 520 x 85	White or Buff	38.0	£102.09
Corbels				
Corbels	665mm x 100 x 215	Buff	27.0	£52.96
Gable Vents				
Gable Vents	590mm x 328 x 100	Buff	36.6	£120.79
String Course (bandcourse / stringer)				
String	890mm x 157 x 140	Buff	34.0	£61.78
Bullseye Window Surrounds				
Bullseyes	See drawing	Buff	98.0	£266.32

Notes:

- Rates are based on supply only; prices exclude VAT and delivery;
- All sizes and weights approximate;
- Standard Addstone (UK) Limited conditions of sale apply;
- Addstone (UK) Limited operate a policy of continuous development and as such product specification and details are subject to change without notice;
- This document supersedes all previously published prices. All goods will be charged at prices ruling at the date of purchase E&OE;
- Heads are non-loadbearing and must be used in conjunction with suitable steel supporting lintel.

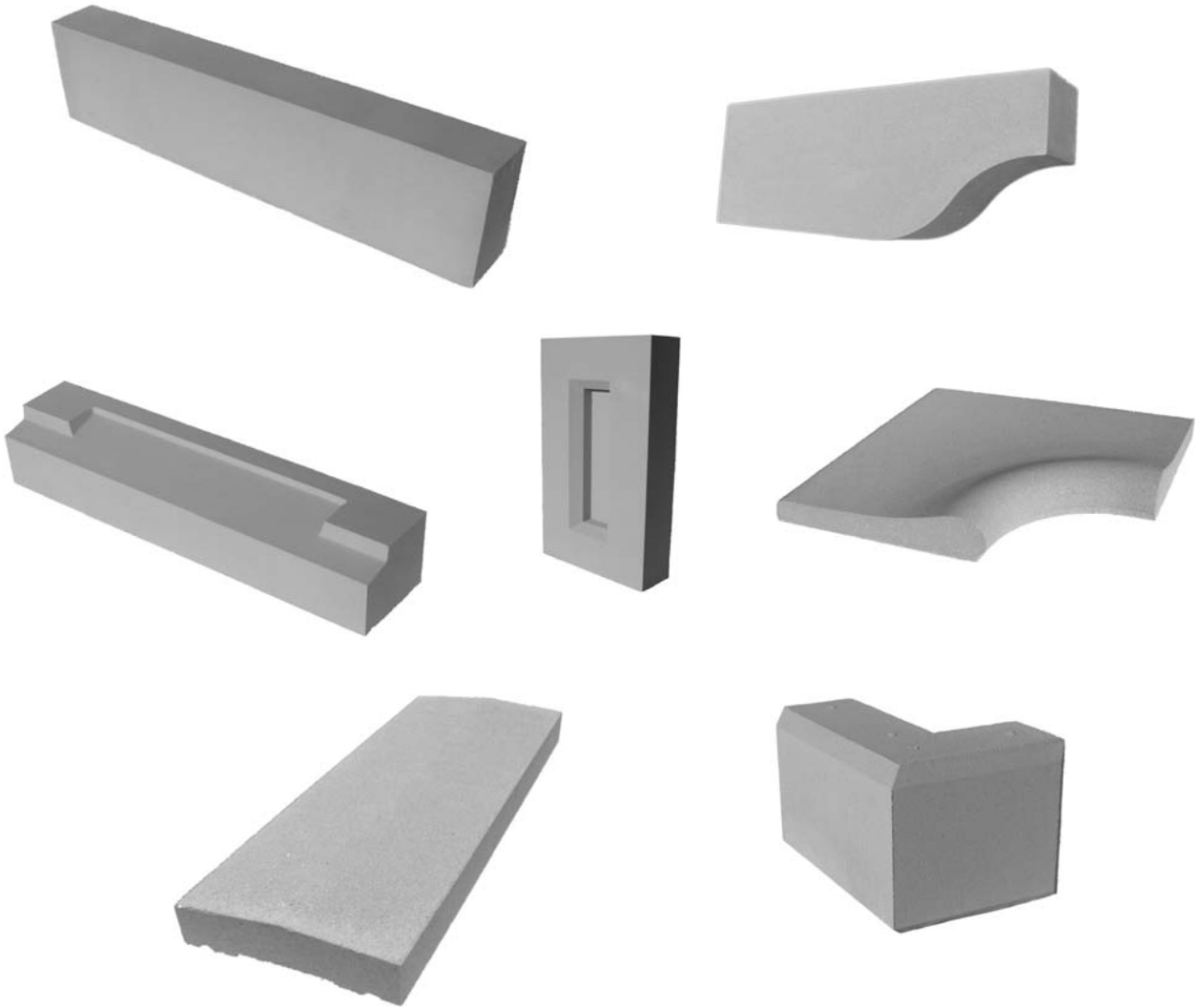

AddstoneTM
Cast Stone from STOCK